

**Welcome to
Year 6
Classes 13
and 14**



JH

Class 13:
Miss
McCulloch



Class 14: Mr
Harper



Academic mentor:
Miss Ryan



Timetables

JH

TUESDAY:

Teacher's planning time (PPA).
Mrs Young - Class 13 morning
Class 14 - afternoon

WEDNESDAY:

Indoor PE (come to school in PE uniform)

FRIDAY:

Outdoor PE (come to school in PE uniform)
Diaries checked in both classes

UNIFORM

JH

Old Basford School Uniform

School Uniform

- Black or grey pinafore dress or skirt, with plain black or grey tights.
- Plain black or grey school trousers.
- A plain white blouse, shirt or polo shirt
- Plain black or grey school shorts of a suitable length.
- School summer dress, blue and white check. (White leggings may be worn to accompany this)
- Royal blue sweatshirt or cardigan with the school logo only
- Well fitted, flat black shoes or plain black unbranded trainers with black laces
- Suitable black boots may be worn in winter.
- During the summer, a suitable black or white canvas shoe or strong strapped sandal may be worn.
- One small pair of stud earring and any religious items are accepted – removed for PE days
- Small hair accessories in school colours royal blue, black or white.
- Religious headwear in school colours royal blue, black or white.

PE Uniform (to be worn on designated PE days)

- Plain white t-shirt,
- Plain Black shorts (no sports logos)
- Plain black/white trainers
- Plain black joggers/leggings
- Plain black jumper/hoodie (no sports logos)

No thank you to:

- Hoop or dangly earrings
- UGG style boots
- Open toed sandals, flip flops, crocs or any other type of current fashionable footwear)
- Heeled shoes/boots
- Large hair accessories (bigger than a fist)
- Fashion trends such as make up, nail varnish, colour hair extensions, hair dye, tattoo transfers, fashion haircuts (this list is inclusive but not exhaustive)
- Coloured trainers
- Large branded/logo clothing

BEHAVIOUR: PROUD RULES

HM



Polite & helpful

PROUD POINTS

Respect

Organised and Tidy

Understanding others needs

Do your best

RECOGNITION BOARD

HM

Children who go 'above and beyond' will be placed on the class 'Recognition Board' and will receive a Proud Point via Arbor.

They then have special treat time with Mrs Duffin on a Friday assembly.

Behaviour Policy

HM

Remind, Reflect, Regulate and Restore

Give positive praise to others around who are showing the correct behaviour.

Discreetly remind the child of the behaviour expectations and school rules.

Give a final reminder of behaviour expectations and the school rule we would like them to follow, if they continue to not follow the rules they will be asked to move in to reflection time.



Reflection - 5 minutes with a timer in the class reflection space.

Regulate - a short conversation between the child and the adult about why they are in reflection time and the behaviour that the adult wants to see in class.

Restore - Child returns to the classroom and continues learning with the class.

At the next break, the child stays for 5 minutes with the timer to restore the learning they have lost. In some cases, this may not be appropriate and a conversation with an adult to help build relationships will be had instead.

SATS tests - Week beginning Monday 11th May

Maths

Paper 1 - 30 minutes (Arithmetic)

Paper 2 - 40 minutes (Reasoning)

Paper 3 - 40 minutes (Reasoning)

JH

Grammar

Paper 1 - 45 minutes (Grammar and Punctuation)

Paper 2 - Spelling (20 words)

Reading

Reading booklet and answer booklet (1 hour to read and answer)

Writing

Teacher assessed in school.

**Old Papers will
be sent home**

HOMework: SPELLING HM

Each week the children will be given ten spellings which follow a pattern and we will have daily time to practise these spellings using a range of fun and helpful activities. You can support them to practice their weekly spellings as well as the common exception words that have been sent home electronically.

Practising their spellings little and often, making it fun is key to helping your children to become confident and successful spellers.

★ Year 3 and 4 Common Exception Words ★

Aa Bb Cc Dd Ee Ff Gg Hh Ii Jj Kk Ll Mm Nn Oo Pp Qq Rr Ss Tt Uu Vv Ww Xx Yy Zz

Aa accident accidentally actual actually address although answer appear arrive	Bb believe bicycle breathe build business busy	Cc calendar caught centre certain circle complete consider continue	Dd decide descend different difficult disappear	Ee early earth eight right enough exercise	Ff famous February forward forwards fruit	Gg grammar group guard guide	Hh heard heart height history	Ii imagine increase important interest island
Ll learn length library	Mm material medicine minutes minute	Oo occasion occasionally often opposite ordinary	Pp particular perhaps popular position possession possible potatoes pressure probably promise purpose	Rr recent regular reign remember	Ss sentence separate special straight strange strength suppose surprise	Tt therefore though thought through	Vv various	Ww weight woman women

★ Year 5 and 6 Common Exception Words Mat ★

Aa Bb Cc Dd Ee Ff Gg Hh Ii Jj Kk Ll Mm Nn Oo Pp Qq Rr Ss Tt Uu Vv Ww Xx Yy Zz

Aa accommodate according aggressive amateur assess appreciate attach available average awkward	Bb bargain bruise	Cc category committee communist community competition conscience conscious controversy convenience correspond	Dd definite desperate develop dictionary distrust	Ee embarrass environment equipment especially exaggerate excellent existence explanation	Ff familiar foreign forty frequently	Gg government guarantee	Hh harass hindrance	Ii identity immediate individual interfere interrupt
Ll language leisure lightning	Mm marvellous mischievous muscle	Pp parliament persuade physical privilege profession programme pronunciation	Rr recognise recommend relevant restaurant rhyme rhythm	Ss sacrifice secretary shoulder signature sincere sincerely soldier stomach suggest symbol system	Tt temperature thorough twelfth	Vv variety vegetable vehicle	Yy yacht	

ar or ur ow oi ear air ure or oi ee igh oa oo
ch sh th ng qu ss ff ll zz

Year 6 Term 1A Overview

Objectives that are in pink are a Y5/Y6 statutory requirement and individual words highlighted pink are from the Y5/Y6 statutory spelling list. The additional sets either: revise previously visited spelling rules from lower year groups; practise a spelling rule linked to a Y5/Y6 statutory spelling word or relate to a word, sentence or punctuation objective from the English Appendix 2 of the NC 2014.

Week 1 Ambitious Synonyms: Adjectives	Week 2 Homophones & Near Homophones: Nouns that end in -ce/-cy and verbs that end in -se/-sy	Week 3 Adjectives ending in -ant into nouns ending in -ance/ -ancy	Week 4 Adjectives ending in -ent into nouns ending in -ence/ -ency	Week 5 Hyphens: To Join a prefix ending in a vowel to a root word beginning with a vowel.	Week 6 Hyphens: To Join compound adjectives to avoid ambiguity	Week 7 Review Week
aggressive	advice	observant	innocent	co-operate	man-eating	Within this review week, use the provided Year 6 Autumn Term 1 Dictation Passages and the Spot the Mistake with Mr Whoops self-correction activities to assess pupil's progress against the objectives that have been covered within this half-term.
hostile	advise	observance	innocence	co-ordinate	little-used	
awkward	device	expectant	decent	co-own	rock-bottom	
obstinate	devise	expectancy	decency	co-author	wide-eyed	
desperate	licence	hesitant	excellent	re-enter	pig-headed	
frantic	license	hesitancy	excellence	re-educate	tight-fisted	
disastrous	practice	tolerant	confident	re-examine	cold-hearted	
calamitous	practise	tolerance	confidence	re-evaluate	stone-faced	
marvellous	prophecy	relevant	existent	re-energise	green-eyed	
spectacular	prophesy	relevance	existence	re-elect	short-tempered	

HOMEWORK: MATHS

HM



The expectation is to practise times tables on TTRS at least 3 times a week.

HOMework:

Maths.com/SPAG.co.uk JH

Your child has received a log in for Maths.co.uk and Spag.com.

We will be setting weekly homework for the children to complete using these websites.

The children will have a week to complete their homework task.

Homework will be set on a Friday and checked the following Friday

1 Count in 7s and complete the grid.



		28		
21	<input type="text"/>	35	42	
		42		
		<input type="text"/>		
		56		

1 mark

Show Answers: OFF [Next >](#)

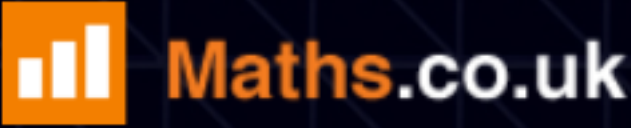

2 Match the correct **suffix** to each word.

Show Answer OFF

hood hood hood ship ship ship

child
champion
neighbour
friend
member

1 mark

[< Previous](#) [Next >](#)



HOMEWORK: CGP REVISION BOOKS

HM

In January, your child will receive 3 revision books to help with their preparation at home for their SATS.

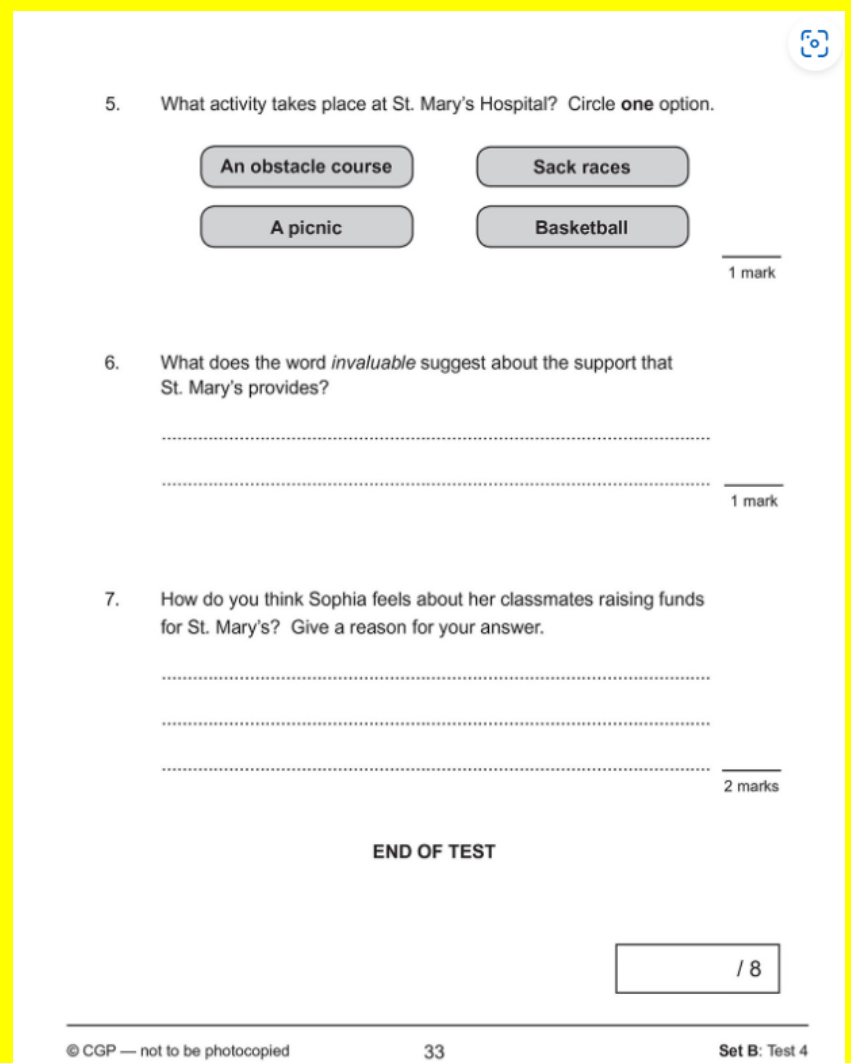
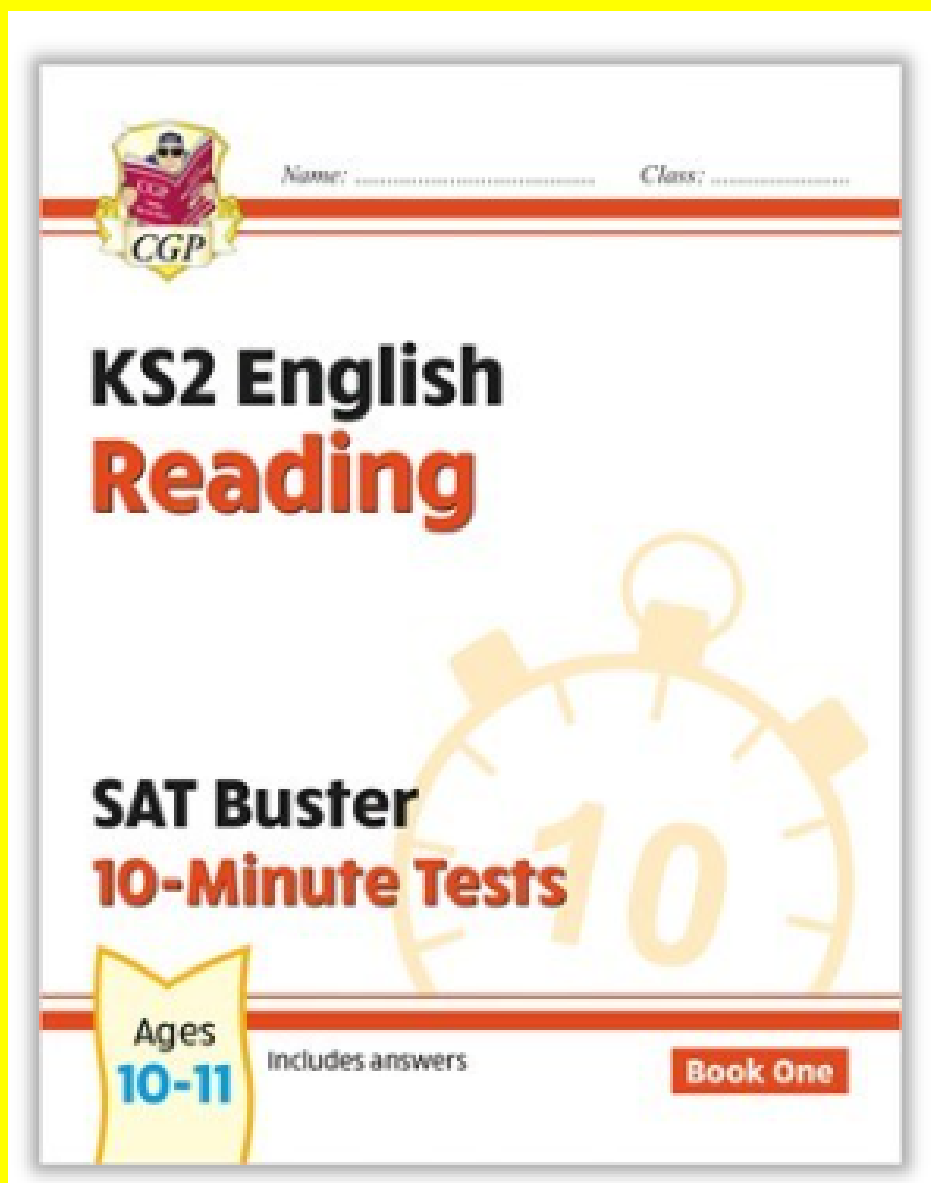

CREATIVE TOPIC HOMEWORK

CASTAWAY

This half term, Year 6's topic is Castaway. We will be learning about rivers, mountains and living things.

Some ideas for creative homework:

- Research a mountain in the UK. Can you find it on a map? How tall is it?

- Create a fact file about a river. Can you compare it to a river in a different country?



- Design a survival kit. Decide what you would include in a survival bag to trek up the Himalayan Mountain Range. You can only take 10 items. What will you need? Explain why you think they are necessities.



- Landscape Picture – use paints, crayons or felt tips to draw a landscape picture including mountains or a river.



- Design and make a bridge to cross a busy river. What will you make it of? How will you make it a strong structure?



ANY OTHER CREATIVE IDEAS ARE WELCOMED!

Please bring your homework to school on Monday 13th October

As in previous years, each half term the children will receive a piece of topic homework that they get a few weeks to complete. It will be linked to our half termly topic and we would like the children to 'think outside of the box' and complete something creative linked to our topic.

We will showcase all work at school so the children get a chance to show off what they have completed.

JH

YEAR 6 IS AN ESSENTIAL YEAR...

So we ask you kindly not to book holidays during the academic term time. This is vital in the build up to SATS week and ALSO after as we assess the children's writing for up to a month after the tests.

Secondary School

JH



You will soon receive a letter about applying for secondary school.

Deadline is the 31st October.

Please come and see one of us if you have any problems.

You will find out on March 1st which school you have been allocated.

YEAR 6 AWARDS

HM

- The Hyde Science award
- Star writer
- Star mathematician
- Precious Sports boy and girl
- Anderton Fair Play award
- Kearney Creative award
- Davies cup of kindness
- Eccleston Unsung hero
- Shaw endeavour award
- **Children's Star of Basford**
- **The Clifford Star of Basford**



Things to look forward to!

HM

- Wow Days at the start of each topic
- Visit to Holocaust Museum (January)
- **Residential to Kingswood (24th -26th June)**
- The opportunity to represent school in lots of competitions.
- Roles and responsibilities
- Leavers Disco (22nd July 6-8pm)
- Leavers Assembly



Website

HM

Year Group Pages 2024-2025

Home > Children > Year Group Pages 2024-2025



Foundation 1



Foundation 2



Year 1



Year 2



Year 3



Year 4



Year 5



Year 6

Go to 'Children' tab

FIRST WEEK BACK - WEEK BEGINNING 1st SEPTEMBER

We have had an EXCELLENT first week back and we have started the year on a high. All of our Year 6 students have shown us that they are ready to be the oldest children in our school, be role models to the younger pupils and lead by example. Many students have signed up to roles and responsibilities around school which is extremely POLITE & HELPFUL. We have completed many baseline assessments this week and the children tackled them with drive and resilience. Well done Year 6 - we can't wait to see what you all achieve this year!



HM



If you have any questions please feel free to stay behind and ask one of the Year 6 team.

You can always contact us by writing a note in your child's diary, catching us at the end of the school day or you could call the office and they will pass a message on to us and we can call you back if necessary.